

The South Point Hotel and Casino consists of a 25 story hotel tower and 90,000 square feet (8,400 m²) convention center located on a 60 acres (24 ha) site along Las Vegas Boulevard in Enterprise, Nevada. The casino is owned and operated by Michael Gaughan.

History

This \$500 million project started construction in 2003, under the South Coast name. Based on advanced booking, Coast Casinos announced expansion plans to add additional hotel rooms, with a second tower, for a total of 1,350 rooms. The foundation was also poured for a possible third tower during the initial construction phase.

The casino received approval to open from the Nevada Gaming Commission on November 17, 2005. At opening on December 22, 2005, the South Coast was the first megaresort located south of McCarran International Airport and the Las Vegas Strip. The hotel contained 662 rooms and 800,000 sq ft (74,000 m²) of space that was not finished and was available to be converted into restaurant or casino space.

In mid July 2006, it was announced that Michael Gaughan would sell all of his Boyd stock to Boyd gaming in exchange for full ownership of the South Coast. The Nevada Gaming Commission approved the sale on October 19, 2006. After the deal closed, the South Coast was renamed South Point on October 24.

On August 24, 2007 the South Point announced an 830 room expansion with construction of the third hotel tower, turning the hotel towers into a "T"-shaped facility as seen from above. The \$95 million expansion, planned for completion in July 2008, would add 10,000 sq ft (930 m²) of convention space and 5 food and beverage locations. The third tower opened on July 21, 2008 with the hotel now offering a total of 2,163 rooms and 160,000 sq ft (15,000 m²) of meeting and convention space; the largest of any Las Vegas hotel.

Television history

During 2006, the South Point was the venue of NBC's Poker After Dark, ESPN's Pro-Am Poker Equalizer and the third and fourth season of GSN's High Stakes Poker.

The South Point has been the host site for the Jerry Lewis MDA Telethon since 2006.

Attractions

400 seat Showroom

300 seat race and sports book

160,000 sq ft (15,000 m²) of meeting, banquet, and exhibit hall space

A 16 screen movie theater

A 64 lane bowling alley with pro shop

8 restaurants

Bingo Room

Poker Room

4,400 seat equestrian arena with a 125 by 250 ft (38 by 76 m) arena with accommodations for 1,200 horses. At opening, it is the only equestrian arena connected to a hotel in the United States. The stalls are also Air-Conditioned.



South Point Arena & Concourse

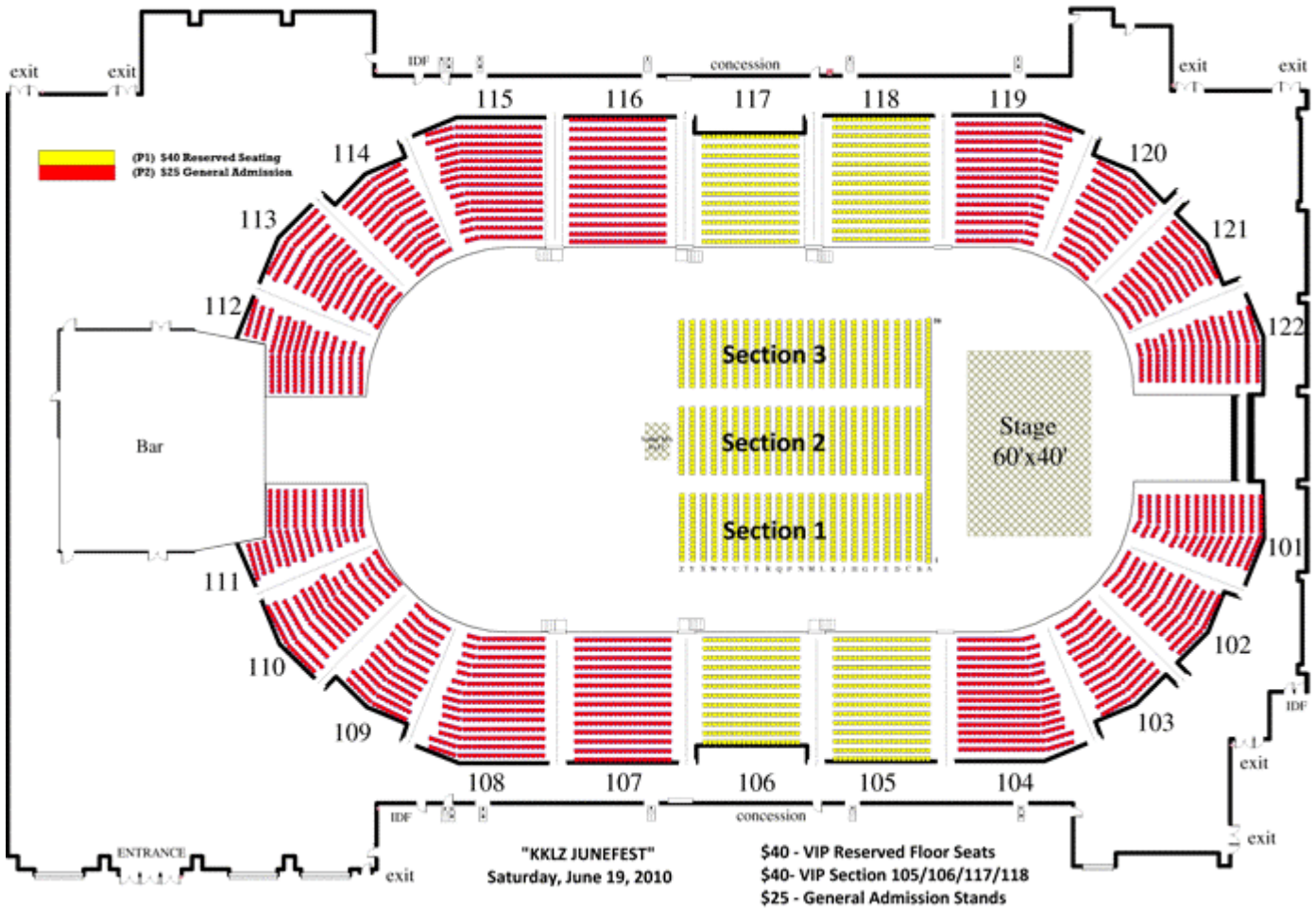
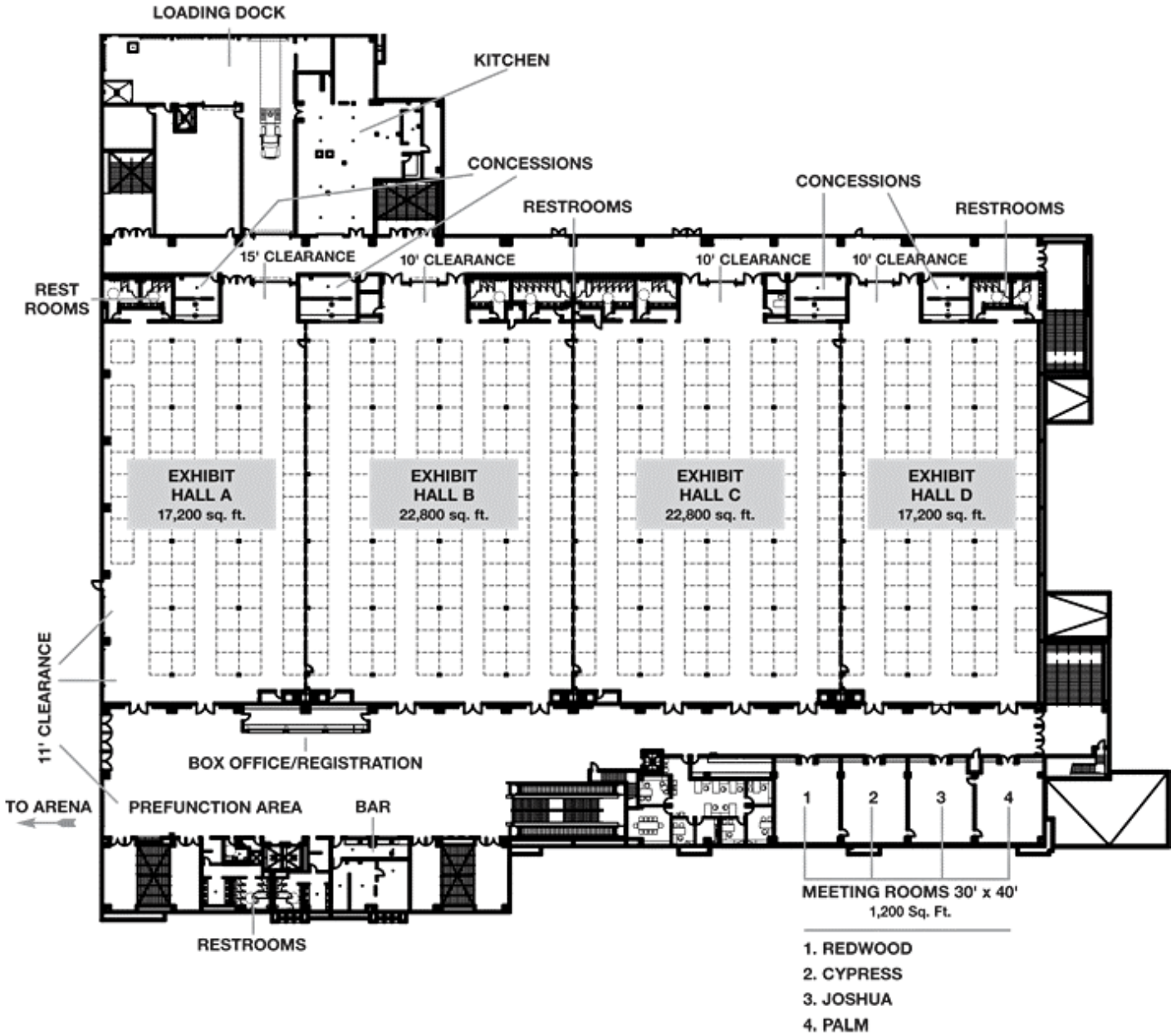

EXHIBIT HALLS



LOADING DOCK

KITCHEN

CONCESSIONS

RESTROOMS

CONCESSIONS

RESTROOMS

15' CLEARANCE

10' CLEARANCE

10' CLEARANCE

10' CLEARANCE

REST ROOMS

EXHIBIT HALL A
17,200 sq. ft.

EXHIBIT HALL B
22,800 sq. ft.

EXHIBIT HALL C
22,800 sq. ft.

EXHIBIT HALL D
17,200 sq. ft.

11' CLEARANCE

BOX OFFICE/REGISTRATION

TO ARENA

PREFUNCTION AREA

BAR

MEETING ROOMS 30' x 40'
1,200 Sq. Ft.

RESTROOMS

- 1. REDWOOD
- 2. CYPRESS
- 3. JOSHUA
- 4. PALM